

## TURBO-LUX 3

Orifice Plate Flowmeter

FM, LPCB and VdS approved



## **IMPRINT**

All rights reserved. Any reproduction or usage without written authorisation of MECON GmbH - even partial content - is strictly prohibited.

Subject to change without notice.

Copyright 2016 by MECON GmbH - Röntgenstr. 105 - 50169 Kerpen - Germany

---

## CONTENTS

<b>1 SAFETY INSTRUCTIONS</b> .....	<b>4</b>
1.1 Intended use.....	4
1.2 Certifications.....	4
1.3 Safety instructions from the manufacturer.....	5
<b>2 DEVICE DESCRIPTION</b> .....	<b>6</b>
2.1 Scope of delivery .....	6
2.2 Nameplate .....	7
<b>3 INSTALLATION AND MODE OF OPERATION</b> .....	<b>8</b>
3.1 Installation notes .....	8
3.2 Installation instructions .....	9
3.3 Mode of operation .....	10
<b>4 START-UP</b> .....	<b>11</b>
<b>5 TECHNICAL DATA</b> .....	<b>13</b>
5.1 Dimensions and weights.....	14
<b>6 DESCRIPTION CODE</b> .....	<b>16</b>
<b>7 SERVICE</b> .....	<b>18</b>
7.1 Storage.....	18
7.2 Maintenance.....	18
7.3 Returning the device to the manufacturer.....	18
7.4 Disposal.....	19

## 1 SAFETY INSTRUCTIONS

### 1.1 Intended use

The orifice plate flowmeter Turbo-Lux 3 is used to measure the volume of water in closed conduits. It is suitable for any point of installation, mounting position and flow direction (in compliance of the directional arrow).

The necessary approvals of the FM Approvals, LPCB and VdS Schadenverhütung GmbH are available.



#### **Warning!**

*The operator of these measuring devices is solely responsible for the suitability, intended use and corrosion resistance of the selected materials. It must be particularly ensured that the materials selected for the wetted parts of the flowmeter are suitable for the process media to be measured.*

*The manufacturer is not liable for any damage resulting from improper or unintended use of these devices.*

*The device may only be used in the operating instruction specified pressure and temperature limits.*

### 1.2 Certifications

- » **FM Approval Class: 1046**
- » **LPCB Approval LPS 1045**
- » **VdS Approval 2344, 2100-29**

### 1.3 Safety instructions from the manufacturer

The manufacturer is not liable for damages of any kind caused by the use of the device, including, but not limited to direct, indirect, incidental, punitive and consequential damages.

For every product purchased from the manufacturer warranty applies, according to the relevant product documentation and the valid terms and conditions.

The manufacturer reserves the right to revise the content of the documents, including this disclaimer, without notice, and is not liable in any way for possible consequences of such changes.

The responsibility that the instruments are suitable for the particular application rests solely with the operator. The MECON GmbH assumes no liability for the consequences of misuse, modifications or repairs that were carried out by the customer without prior consultation.

In case of a complaint the contested elements must be cleaned of hazardous substances and to be returned to the manufacturer unless otherwise agree (see 7.3).

To prevent injury to the user or damage to the unit, it is necessary that you reading this operating instruction carefully before starting using the device.

The instruction is intended for both the correct installation, operation and maintenance of the equipment.

Special designs for special applications and custom models are not covered by this documentation.

## 2 DEVICE DESCRIPTION

### 2.1 Scope of delivery



Fig. 1 Scope of delivery

- ① Orifice plate flowmeter Turbo-Lux 3
  - ② Operating instructions
  - ③ Certificate (option)
- Replacement gaskets (not shown here)

## 2.2 Nameplate

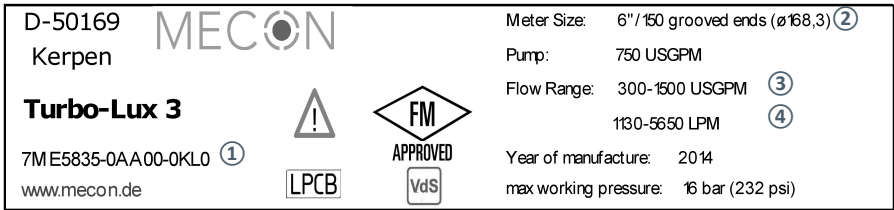
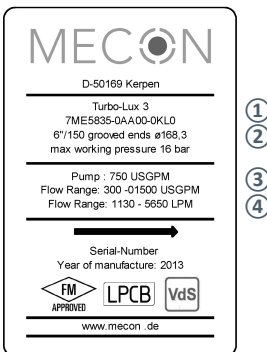

Fig. 2 Nameplate bypass meter Turbo-Lux 3



- ① Description code / Order code
- ② Nominal size and process connection
- ③ Flow range (USGPM)
- ④ Flow range (LPM)

Fig. 3 Nameplate orifice plate

## 3 INSTALLATION AND MODE OF OPERATION

### 3.1 Installation notes



#### Information!

*All instruments are carefully checked for proper function before shipment. Check immediately on receipt, the outer packing carefully for damage or signs of improper handling.*

*Report damage to the carrier and your locale sale staff. In such cases, a description of the defect, the type and the serial number of the device is indicated.*

*Unpack the unit carefully to avoid damage.*

*Check the completeness of the delivery against the packing list. Check the name plate, if the delivered flow meter according to your order.*

*Special requirements VdS: The version with rolled grooved ends may only be used in combination with VdS-approved pipe couplings manufactured by Anvil (Gruvlok mechanical grooved couplings), Jinan Meide (casting couplings type 1G), Minimax, Modgal, Tyco (Grinnell Mechanical und G-Fire steel IPS couplings) and Victaulic (except pipe couplings of the type "Style 77").*



### 3.2 Installation instructions

#### Installation of the orifice plate

Before and after the orifice plate a straight calming section is provided as a function of the nominal diameter (D). When using valves and fittings before the orifice plate, an inlet path of min.  $10 \times D$  is always required. For the standard version an inlet path of min.  $10 \times D$  and an outflow zone of min.  $5 \times D$  is required (fig. 4). The connected pipes have to be of the same size as the orifice plate.

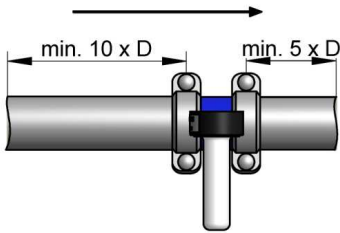

Fig. 4 Inlet path and outflow zone

For some flow ranges a special version for shortened inlet path of  $5 \times D$  and shortened outflow zone of min.  $2 \times D$  is available (fig. 4). Before installation, following conditions have to be observed:

- » **A straight inlet path of  $5 \times D$  is required. A longer inlet path is not allowed.**
- » **The inlet path has to be connected directly to a one quarter pipe.**

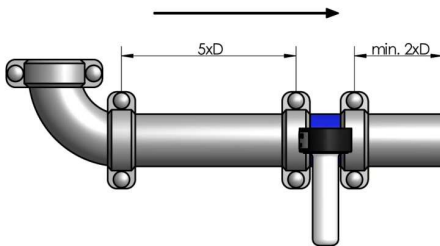

Fig. 5 Shortened inlet path and outflow zone

The installation can be in any line routing - horizontal to vertical - place (fig. 6). However, it is important to ensure that the flow direction of the arrow marked on the device and corresponds to the differential pressure sampling tube (fig. 9/10, pos. 7) is in the horizontal position.

For attachment of the bypass meter, sufficient clearance must be provided. Important for the compliance of the measuring tolerance is the central mounting of the pipeline. The center offset must not exceed 0.5 mm.

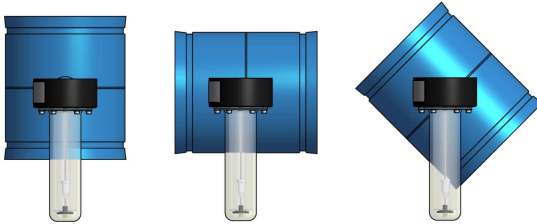

Fig. 6 Examples of installation

### Mounting the bypass meter

The bypass meter is only compatible with the delivered orifice plate. Please make sure that the serial number of the orifice plate and the bypass meter are similar before installation. Before loosening the cap (fig. 9/10, pos. 10), the pipeline must be emptied to prevent the escape of liquids. The meter is plugged and screwed with a nut (fig. 9, pos. 9).

It must always be mounted vertically so that the float (fig. 9, pos. 4) can move freely in the tube. About foreign bodies that have come behind the filter must be removed (see 7.2). The tightening of the nut or the cap should be done by hand as possible. The threads must - for example be slippery - by fat. To avoid air strikes, the tube should be slowly filled with water.

### 3.3 Mode of operation

The orifice plate flowmeter Turbo-Lux 3 consists of an orifice plate (fig. 9/10, pos. 1) for stationary installation and a portable bypass meter (fig. 9, pos. 2). The bypass meter contains a conical glass tube (fig. 9, pos. 3) with float (fig. 9, pos. 4). The water flows vertically from top to bottom through the flow tube at the upper end of a side panel (fig. 9, pos. 5) is arranged. A filter (fig. 9, pos. 13) at the inlet largely prevents the ingress of foreign bodies. Inlet and outlet port for the bypass to be measured are arranged concentrically, so that an easy to combine with the stationary primary element.

## 4 START-UP

Read the exact value when a consistent flow has been attained and the float has reached a stable position. The pipeline must always be filled. Read the value at the greatest diameter (upper edge) of the float:

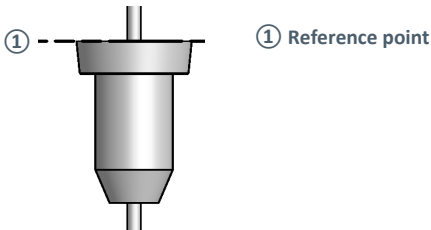

Fig. 7 Float

For the bypass meter it is important that when starting up the pump, the shut-off/control valve of the bypass orifice is opened min. 30% to avoid hydraulic shocks or pressure surges that could damage the bypass meter.

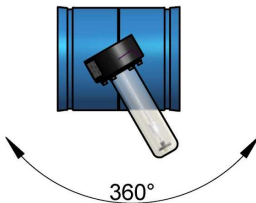

Fig. 8 Rotation bypass meter

When the bypass meter is commissioned or set into operation, bubbles of air will initially accumulate at the top part, which must be removed. For this purpose, the union nut (fig. 9, pos. 9) must be somewhat loosened during operation and the device must be rotated by 360°, so that the air bubbles can escape. Then the bypass meter has to be positioned vertically and the union nut has to be tightened once again.



**Before pressure test in pipes, the bypass meter has to be disassembled and the connection of the orifice plate has to be screwed pressure-tight with the cap.**

**Read the exact value**

On the scale the flow is printed in LPM (liters per minute respectively  $dm^3/min.$ ), USGPM (U.S. gallons per minute) and as percentage (100% = rated power of the pump) for each nominal size and range. The following table provides more information about the scale display.

Nominal Size	Pump rating (USGPM)	Flow range (USGPM)	Step (USGPM)	Graduation (USGPM)	Flow range (lpm)	Step (lpm)	Graduation (lpm)
2"/DN 50	50	20 - 100	10	5	75 - 375	50	5
2 <sup>1/2</sup> "/DN 65	100	40 - 200	20	4	150 - 750	100	5
3"/DN 80	150	60 - 300	50	5	220 - 1100	200	4
3"/DN 80	200	80 - 400	50	5	300 - 1500	200	4
4"/DN 100	250	100 - 500	50	5	380 - 1900	200	4
4"/DN 100	300	120 - 600	100	5	460 - 2300	200	4
4"/DN 100	400	160 - 800	100	5	600 - 3000	500	5
4"/DN 100	450	180 - 900	100	5	680 - 3400	500	5
6"/DN 150	500	200 - 1000	100	5	760 - 3800	500	5
6"/DN 150	750	300 - 1500	200	4	1130 - 5650	1000	5
6"/DN 150	1000	400 - 2000	200	4	1500 - 7500	1000	5
6"/DN 150	1250	500 - 2500	500	5	1900 - 9500	1000	5
8"/DN 200	1500	600 - 3000	500	5	2200 - 11000	2000	4
8"/DN 200	2000	800 - 4000	500	5	3000 - 15000	2000	4
8"/DN 200	2500	1000 - 5000	1000	5	3800 - 19000	2000	4
8"/DN 200	3000	1200 - 6000	1000	5	4500 - 22500	2000	4
10"/DN 250	3500	1400 - 7000	1000	5	5300 - 26500	5000	5
10"/DN 250	4000	1600 - 8000	1000	5	6000 - 30000	5000	5
10"/DN 250	4500	1800 - 9000	1000	5	6800 - 34000	5000	5
12"/DN 300	5000	2000 - 10000	1000	5	7600 - 38000	5000	5

Table 1 Scale graduation

**After device usage**

After the measurement, the bypass meter is unscrewed, emptied and put back into the packaging. However, make sure in advance that the pipeline is empty and without pressure. The open orifice plate must be sealed pressure-tight with the cap again.

## 5 TECHNICAL DATA

<b>Measuring principle</b>	Orifice plate flowmeter with variable flowmeter as indication
<b>Input</b> » Nominal Size  » Pressure limit	2"/DN 50 grooved ends (Ø60,3 mm) 2½"/DN 65 grooved ends (Ø76,1 mm) 3"/DN 80 grooved ends (Ø88,9 mm) 4"/DN 100 grooved ends (Ø114,3 mm) 6"/DN 150 grooved ends (Ø165,1 mm) 6"/DN 150 grooved ends (Ø168,3 mm) 8"/DN 200 grooved ends (Ø219,1 mm) 10"/DN 250 grooved ends (Ø273,0 mm) 12"/DN 300 grooved ends (Ø323,9 mm) PN 16 (232 psig)
<b>Measuring accuracy</b>	±2 % of full scale value (FM) ±5 % of measured value (LPCB) ±2,5 % of full scale value (VdS)
<b>Application conditions</b> » Temperature limit » Medium	+4°C to +50°C (+39°F to +122°F) Water
<b>Design/ Material</b> » Orifice plate 2"/DN 50 - 4"/DN 100  » 6"/DN 150 - 12"/DN 300  » Differential pressure sampling tube » Float » Bypass orifice » Filter » Seal	Housing tube in stainless steel with turned grooved connection coated steel with rolled grooved connection /optional in stainless steel  Brass Stainless steel Stainless steel Stainless steel NBR
<b>Certifications</b>	FM Approval 0003044464 LPCB Certificate Number 1385a VdS G415006

5.1 Dimensions and weights

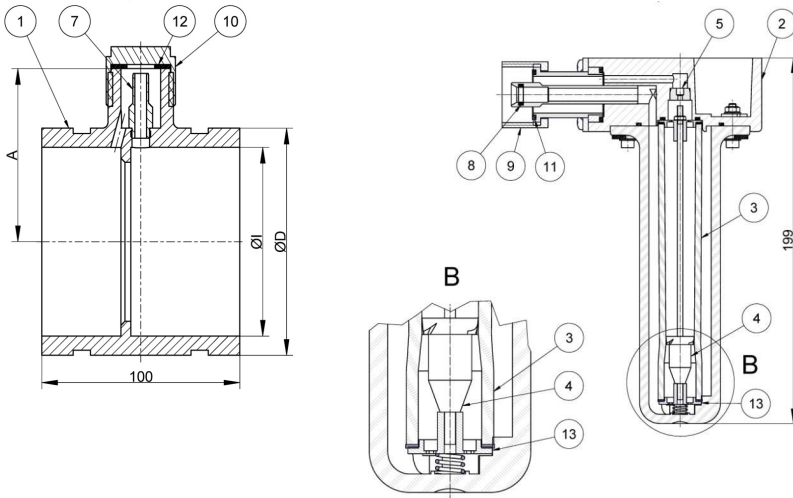

- ① Housing tube
- ② Bypass meter
- ③ Measuring tube
- ④ Float
- ⑤ Bypass orifice
- ⑦ Differential pressure
- ⑧ O-Ring
- ⑨ Screw cap
- ⑩ Cap
- ⑪ O-Ring
- ⑫ Seal
- ⑬ Filter

Fig. 9 Turbo-Lux 3 orifice plate and bypass meter, Drawing and dimensions 2"/DN 50 - 4"/DN 100

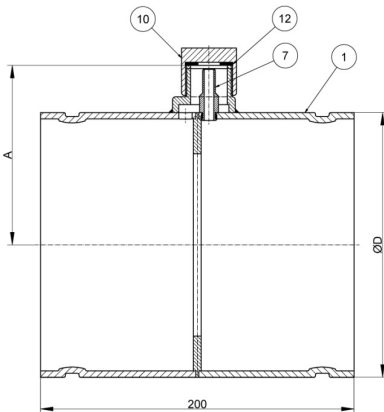

Fig. 10 Turbo-Lux 3 orifice plate, Drawing and dimensions 6"/DN 150 - 12"/DN 300

Nominal Size	dimensions mm (inch)			Weight incl. packing kg (lbs)
	A (approx.)	ØD	ØI	
2"/DN 50	60 (2.362)	60,3 (2.374)	53 (2.087)	2,0 (4.409)
2½"/DN 65	68 (2.677)	76,1 (2.996)	66 (2.598)	2,1 (4.630)
3"/DN 80	75 (2.952)	88,9 (3.499)	80 (3.150)	2,3 (5.071)
4"/DN 100	87 (3.425)	114,3 (4.499)	100 (3.937)	3,2 (7.055)
6"/DN 150	113 (4.449)	165,1 (6.496)	-	4,9 (10.803)
6"/DN 150	114 (4.488)	168,3 (6.626)	-	4,9 (10.803)
8"/DN 200	140 (5.511)	219,1 (8.626.)	-	6,4 (14.110)
10"/DN 250	166 (6.535)	273,0 (10.784)	-	8,5 (18.739)
12"/DN 300	192 (7.559)	323,9 (12.752)	-	11,0 (24.251)

Table 2 Dimension and weights

Nominal Size	Ø D mm (inch)	Min. thickness	
		min. mm (inch)	max. mm (inch)
2"/DN 50	60,3 (2.374)	2,6 (0.102)	3,6 (0.142)
2½"/DN 65	76,1 (2.996)	2,6 (0.102)	2,9 (0.114)
3"/DN 80	88,9 (3.499)	2,9(0.114)	4,0 (0.157)
4"/DN 100	114,3 (4.499)	3,2 (0.126)	4,5 (0.177)
6"/DN 150	165,1 (6.496)	4,0 (0.157)	5,0 (0.177)
6"/DN 150	168,3 (6.626)	4,0 (0.157)	4,5 (0.177)
8"/DN 200	219,1 (8.626)	4,5 (0.177)	4,5 (0.177)
10"/DN 250	273,0 (10.748)	5,0 (0.197)	5,0 (0.197)
12"/DN 300	323,9 (12.752)	5,6 (0.220)	5,6 (0.220)

Table 3 Dimensions tube of inlet path and outflow zone

## 6 DESCRIPTION CODE

Standard version for inlet path 10 x D and outflow zone 5 x D

**7ME5835 - 0AA00 -**    **0 /** 
  
① ② ③

① Measuring accuracy certificate for orifice plate flowmeter (SET)

0 without  
1 with

② Nominal size/Pump rating

	Nominal size grooved ends	Pump rating USGPM	Flow range		Approval		
			USGPM	LPM	FM	LPCB	VdS
EB	2"/DN 50 (Ø60,3)	50	20 - 100	75 - 375	X	X	X
FC	2½"/DN 65 (Ø76,1)	100	40 - 200	150 - 750	*	X	X
GD	3"/DN 80 (Ø88,9)	150	60 - 300	220 - 1100	X	X	X
GE	3"/DN 80 (Ø88,9)	200	80 - 400	300 - 1500	X	X	X
HF	4"/DN 100 (Ø114,3)	250	100 - 500	380 - 1900	X	X	X
HG	4"/DN 100 (Ø114,3)	300	120 - 600	460 - 2300	X	X	X
HH	4"/DN 100 (Ø114,3)	400	160 - 800	600 - 3000	X	X	X
HJ	4"/DN 100 (Ø114,3)	450	180 - 900	680 - 3400	X	X	X
XK	6"/DN 150 (Ø165,1)	500	200 - 1000	760 - 3800	-	X	X
XL	6"/DN 150 (Ø165,1)	750	300 - 1500	1130 - 5650	-	X	X
XM	6"/DN 150 (Ø165,1)	1000	400 - 2000	1500 - 7500	-	X	X
XN	6"/DN 150 (Ø165,1)	1250	500 - 2500	1900 - 9500	-	X	X
KK	6"/DN 150 (Ø168,3)	500	200 - 1000	760 - 3800	*	X	X
KL	6"/DN 150 (Ø168,3)	750	300 - 1500	1130 - 5650	X	X	X
KM	6"/DN 150 (Ø168,3)	1000	400 - 2000	1500 - 7500	X	X	X
KN	6"/DN 150 (Ø168,3)	1250	500 - 2500	1900 - 9500	X	X	X
LP	8"/DN 200 (Ø219,1)	1500	600 - 3000	2200 - 11000	X	X	X
LQ	8"/DN 200 (Ø219,1)	2000	800 - 4000	3000 - 15000	X	X	X
LR	8"/DN 200 (Ø219,1)	2500	1000 - 5000	3800 - 19000	X	X	X
LS	8"/DN 200 (Ø219,1)	3000	1200 - 6000	4500 - 22500**	X	X	X
MT	10"/DN 250 (Ø273,0)	3500	1400 - 7000	5300 - 26500	*	-	-
MU	10"/DN 250 (Ø273,0)	4000	1600 - 8000	6000 - 30000	*	-	-
MV	10"/DN 250 (Ø273,0)	4500	1800 - 9000	6800 - 34000	*	-	-
NW	12"/DN 300 (Ø323,9)	5000	2000 - 10000	7600 - 38000	*	-	-

\*Approval in process, \*\*VdS-limited flow range

③ /S Housing tube made in stainless steel; option for nominal size 6"/DN 150 up to 12"/DN 300



## Special version for inlet path 5 x D and outflow zone 2 x D

**7ME5835 - 0AA00 -**    **1 /**

①                      ②                      ③

① Measuring accuracy certificate for orifice plate flowmeter (SET)

- 0        without  
1        with

② Nominal size/Pump rating

	Nominal size grooved ends	Pump rating USGPM	Flow range		Approval		
			USGPM	LPM	FM	LPCB	VdS
EB	2"/DN 50 (Ø60,3)	50	20 - 100	75 - 375	X	X	X
FC	2½"/DN 65 (Ø76,1)	100	40 - 200	150 - 750	*	X	X
GD	3"/DN 80 (Ø88,9)	150	60 - 300	220 - 1100	X	X	X
GE	3"/DN 80 (Ø88,9)	200	80 - 400	300 - 1500	X	X	X
HF	4"/DN 100 (Ø114,3)	250	100 - 500	380 - 1900	X	X	X
HG	4"/DN 100 (Ø114,3)	300	120 - 600	460 - 2300	X	X	X
HH	4"/DN 100 (Ø114,3)	400	160 - 800	600 - 3000	X	X	X
HJ	4"/DN 100 (Ø114,3)	450	180 - 900	680 - 3400	X	X	X
XK	6"/DN 150 (Ø165,1)	500	200 - 1000	760 - 3800	-	X	X
XL	6"/DN 150 (Ø165,1)	750	300 - 1500	1130 - 5650	-	X	X
XM	6"/DN 150 (Ø165,1)	1000	400 - 2000	1500 - 7500	-	X	X
KK	6"/DN 150 (Ø168,3)	500	200 - 1000	760 - 3800	*	X	X
KL	6"/DN 150 (Ø168,3)	750	300 - 1500	1130 - 5650	X	X	X
KM	6"/DN 150 (Ø168,3)	1000	400 - 2000	1500 - 7500	X	X	X
LP	8"/DN 200 (Ø219,1)	1500	600 - 3000	2200 - 11000	X	X	X
LQ	8"/DN 200 (Ø219,1)	2000	800 - 4000	3000 - 15000	X	X	X

\*Approval in process

③ /S Housing tube made in stainless steel; option for nominal size 6"/DN 150 bis 8"/DN 200

## 7 SERVICE

### 7.1 Storage

Store the emptied device in a dry and dust-free place. Keep away from direct and permanent sun and heat. Keep away from direct external load to the device. The storage temperature range is -20 to +60 °C (-4 °F to +140 °F).

### 7.2 Maintenance

If the filter is blocked by deposits (fig. 9, pos. 13) the flowmeter must be returned to the manufacturer to be cleaned and tested. Ensure that the O-ring (fig. 9, pos. 8) and the M 30 x 1.5 thread of the orifice plate are lubricated with grease.

### 7.3 Returning the device to the manufacturer

All flowmeters were manufactured in accordance with the highest quality standards and were thoroughly tested prior to shipment.

Should you nevertheless need to return a device to MECON GmbH please observe the following points:



#### **Attention!**

**According to the latest waste disposal directives, the owner/customer is responsible for the waste management of hazardous and toxic waste. For reasons of environmental protection and safeguarding the health and safety of our personnel, all devices sent to MECON GmbH to be repaired must be free of toxic and hazardous substances. This also applies to cavities of the devices. If necessary, the customer is kindly requested to neutralize or rinse the devices before returning them to MECON GmbH.**

The customer has to confirm this by filling in an appropriate form and to be added to the device, which is available for download on the MECON website:

» [www.mecon.de/en/Declaration/Decontamination.pdf](http://www.mecon.de/en/Declaration/Decontamination.pdf)

---

## 7.4 Disposal



*Attention!*

For disposal of equipment are the regulations in your country comply.



## **MECON GmbH**

**Röntgenstr. 105  
D-50169 Kerpen  
Germany**

**Tel.: +49 (0) 2237 600 06 - 0  
Fax: +49 (0) 2237 600 06 - 40  
E-Mail: [info@mecon.de](mailto:info@mecon.de)**

**Web: [www.mecon.de](http://www.mecon.de)**