

Series 723 Three Port Diverter Valve

PRODUCT DESCRIPTION

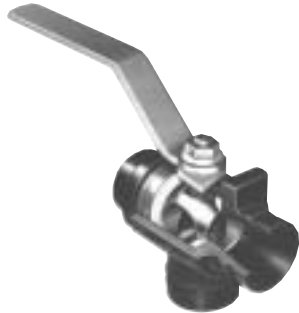

Victaulic Series 723 Diverter valve is a NACE MR-01-75 compliant three-port ball valve with common bottom inlet for diverting flow 90° left or right. 180° operation is optionally available. This valve is rated for 600 psi (4135 kPa) service.

The body is cast of ASTM A-395 ductile iron, painted with black enamel. Internal plastic coating is available. The three-port ball and blowout proof stem are Type 316 stainless steel.

A full stainless body is optionally available. See submittal sheet 17.07.

Victaulic diverter valves are supplied with a standard galvanized carbon steel manual handle. The housing is tapped for mounting brackets to accept actuators. Gear operators as well as a full range of power operators are available.

DIMENSIONS

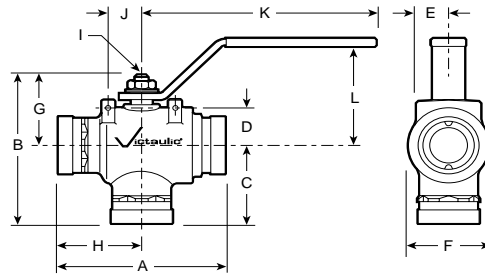

Valve Size		Dimensions Inches/millimeters													Aprx. Wgt. Ea. Lbs. kg	
Nom. Dia. In./mm	Actual Out. Dia. in./mm	A	B	C	D	E	F	G	H	I-Stem Drive Hub			J	K		L
										Dia.	Flat Width	Flat Hgt.				
2	2.375	6.50	6.19	3.25	1.57	1.25	3.13	2.94	3.25	0.62	0.50	0.50	1.31	9.13	4.13	7.5
50	60.3	165	157	83	40	32	80	75	83	16	13	13	33	232	105	3.4

*Bracket hubs are drilled and tapped (1/4-20 UNC-2B, 7/16 DP) in four places for mounting actuator brackets.

PERFORMANCE

Flow Characteristics

Flow testing for the Series 723 Diverter ball valves demonstrated superior flow characteristics. Testing for Vic-Ball valve and competitive valves was performed in our own engineering laboratory facilities with systems and equipment calibrated to National Bureau of Standards.

C_v values for flow of water at +60°F (+16°C) with a fully open valve are shown in table at right.

Formulas for C_v Values:

$$\Delta P = \frac{Q^2}{C_v^2}$$

$$Q = C_v \times \sqrt{\Delta P}$$

Where:

Q = Flow (GPM)

ΔP = Pressure Drop (PSI)

C_v = Flow Coefficient

Valve Size		C _v (Full Open)
Nominal Diameter Inches/mm	Actual Outside Diameter inches/mm	
2 50	2.375 60.3	36

MATERIAL SPECIFICATIONS

Body: Ductile iron conforming to ASTM A-395, painted black enamel coated. NACE MR-01-75 compliant.

- **Optional:** Type 316 stainless steel 2" (50 mm) only (see 17.07).

Ball and Stem: Type 316 stainless steel, 90° turn.

- **Optional:** Type 316SS 180° turn.

Stem Nuts & Washers: Steel, electrogalvanized.

Seals: (TFE) Reinforced Tetrafluoroethylene, rated to +450°F (+232°C). NOTE: Actual fluid temperatures and services may be governed by available gaskets for the Victaulic couplings used for installation. (Refer to Victaulic Gasket Selection Data.)

Operator: (specify choice)

Handle: Stamped carbon steel, electrogalvanized with plastic grip.

- **Optional:** Lock/seal device.
- **Manual gear operator with hand wheel**
 - **Optional:** Memory stop
 - **Power Actuators:** Electric, pneumatic, hydraulic. Contact Victaulic for details.

Ball Valve Numbering System for Series 723 Diverter

B - 020 - 6 6 7 6 15

Type	Size		Pressure Rating	Body	Ball & Stem	Seat	Operator
	Act. In.	Fig. No.					
B	2"	020	6 - 600 psi	6 - Iron-Diverter Body ² 7 - Iron-Diverter Body ² Plastic Coated 9 - Special ¹	7 - 316 Stainless Steel - 90° Diverter Ball 8 - 316 Stainless Steel - 180° Diverter Ball 9 - Special ¹	6 - Reinforced TFE 9 - Special ¹	00 - Bare 15 - 2-position Handle 16 - 2-position Handle with tamper-proof Locking Device

NOTES:

(1) Details required.

(2) All Iron Body valves are NACE compliant.